



WALKER
HOMES

SHEEPBRIDGE PARK



The Canterbury

Two Bedroom, Semi Detached Bungalow

The Canterbury

Two Bedroom, Semi Detached Bungalow

- Spacious open plan living
- Well proportioned design
- Designer kitchen units
- Bi-fold doors
- Two double bedrooms
- Semi detached bungalow
- 680 square feet
- Bath and walk in shower

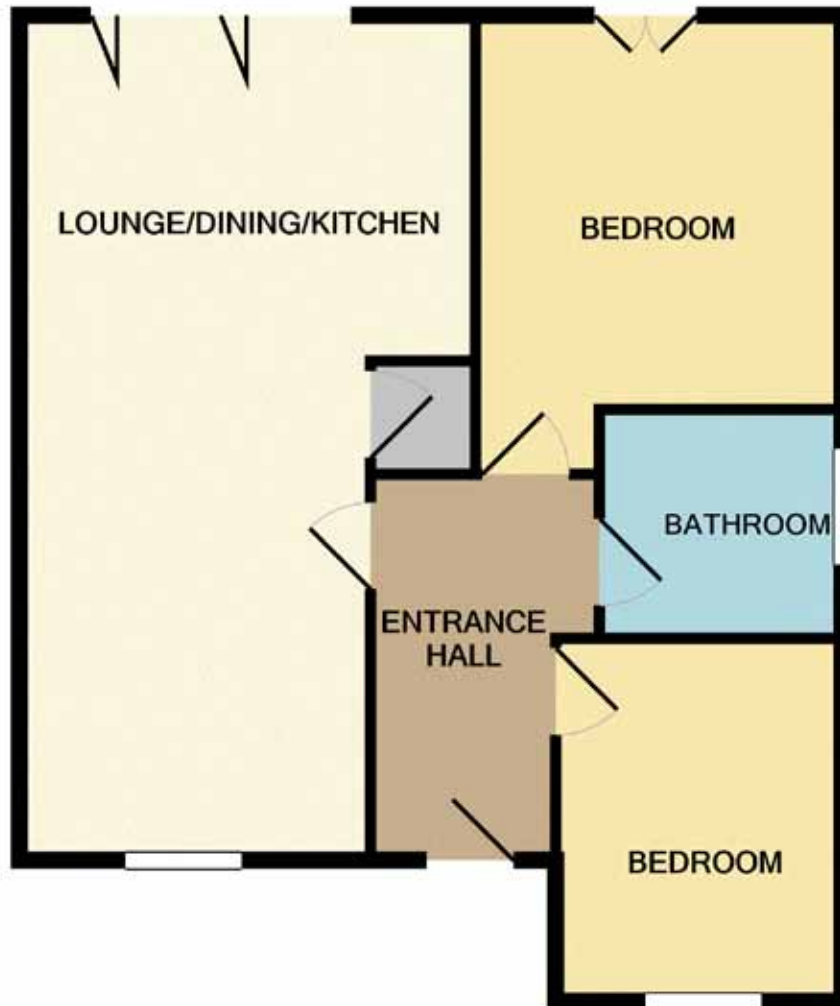

Ground Floor		
Hall	11'5 x 4'3	3.5 x 1.3m
Kitchen/Lounge	8'6 x 3'16	8.6 x 3.16m
Bedroom 1	4'25 x 3'1	4.25 x 3.1m
Bedroom 2	3'4 x 2'4	3.4 x 2.4m
Bedroom 3	2'16 x 2'0	2.16 x 2m

(Approximate dimensions)

All images are for illustrative purposes. These are the dimensions given are illustrative for this house type and individual properties may differ. Please check with your Sales Advisor in respect of individual properties. We give maximum dimensions within each room which includes areas of fixtures and fittings including fitted furniture. These dimensions should not be used for carpet and flooring sizes, appliance spaces or items of furniture. All images, photographs and dimensions are not intended to be relied upon for, nor to form part of, any contract unless specifically incorporated in writing into the contract.